

安定器

陶瓷複金屬燈專用電子式安定器 HID-PV m/S 系列



產品說明

- 微型電子式安定器，一體成型設計，重量輕巧，搭配 CDM 燈管，有 20W 與 35W Mini 以及 35W 三種選擇。

產品特色

- 於燈具中使用，目前供應標準版 (I/S)。
- 20W 產品分為高功率係數 (HPF) 與低功率係數 (LPF) 兩種。
- 市面上體積最小的安定器。
- 使用壽命長達 4 萬小時。
- 品質優異 (< 500 ppm)。
- 採微型化設計，適用於時尚燈具設計，以及更換改裝的鹵素燈。
- 運作安靜無聲。
- 效能不受主電源電壓影響。
- 可輕鬆配合燈具設計。
- 採用推入式接頭，安裝接線都相當方便。

適用場所

- 適用於店面、公共空間、大廳以及辦公室的重點與裝置照明。
- 適用環境：僅適合室內使用。

Electrical data

Type	Number of Lamps (x)	Rated Gear-Lamp Power	Power losses gear (W)	Line Frequency (Hz)	Line Voltage (V)	T-case life (°C)	T-case maximum (°C)	T-ambient
HID-PrimaVision mini 20/S CDM LPF 220-240V 50/60Hz	1	20	3	50/60	220-240	65	75	50
HID-PrimaVision mini 20/S CDM HPF 220-240V 50/60Hz	1	20	4	50/60	220-240	85	85	50
HID-PrimaVision mini 35/S CDM HPF 220-240V 50/60Hz	1	35	6.0	50/60	220-240	85	85	50

HID-PrimaVision mini 20/35 CDM LPF/HPF
220-240V 50/60Hz

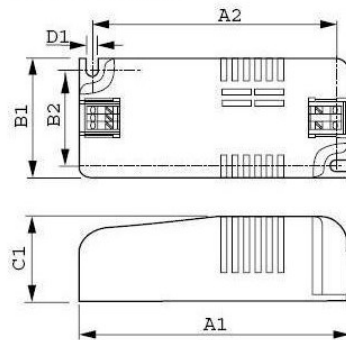

A1 (mm)	A2 (mm)	B1 (mm)	C1 (mm)	D1 (mm)
97.3	88.0	43.3	30.0	4.2

Electrical data

Type	Ignition Voltage (kV)	Cable-Cap outputwires mutual (pF)
HID-PrimaVision mini 1x020/S mCDM LPF 220-240V	1.4	200
HID-PrimaVision mini 1x020/S CDM HPF 220-240V	1.5	200
HID-PrimaVision mini 1x035/S CDM HPF 220-240V	2.0	200

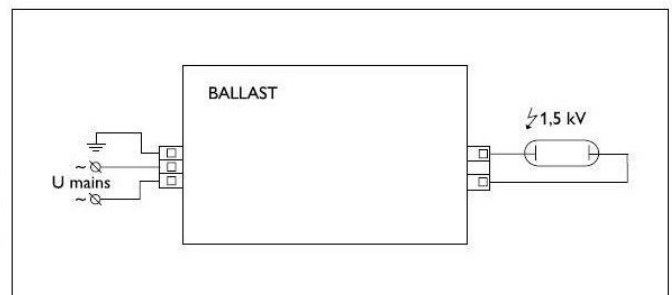

HID-PV m 20/35 LPF/HPF I/S /P

Technical data for installation

Mains operation

Rated mains voltage	230V	
With tolerances for performance:	-10%/+6%	207 – 244V
With tolerances for operation:	189 – 253V	
Mains frequency	50/60Hz	
Mains power factor	0.5	

Lamp operation

Operation frequency (typical)	100Hz
Ignition voltage	1.25kV
Air & creepage distance from any (metal) part that may come live, to earthed environment (class I) or test finger (class II)	>2.5 mm
Cable capacity	Max. 120 pF

Notes:

For proper EMC wiring inside luminaire should be straight and as short as possible: mains wires should not run parallel to lamp wires. Thermo-protected circuit incorporates self-resetting facility; ignition attempts stop after 20 min; mains supply must switched off and on to reset ballast.

Overvoltage protection	48 hrs at 275 Vac
	2 hrs at 320 Vac

Automatic restart after lamp replacement or voltage dip, lamp may take up to 20 min to restart.

Mains current at 230 V

Ballast	Nominal current
HID-PV m 20/S	0,21

Inrush current

Ballast	Max. quantity of ballast per Miniature Circuit Breaker Type B 16 A	Inrush current 1/2 value time at typical mains impedance
HID-PV m 1X020/S CDM	36	30 A / 400 μ s.

Conversion table for max. quantities of ballasts on other types of Miniature Circuit Breaker

MCB type	Rating	Relative number of ballasts
B	16 A	100% (see table above)
B	10 A	63%
C	16 A	170%
C	10 A	104%
L, I	16 A	108%
L, I	10 A	65%
G, U, II	16 A	212%
G, U, II	10 A	127%
K, III	16 A	254%
K, III	10 A	154%

Notes:

1. Data is based on a mains supply with an impedance of 400 m Ω (equal to 15 m cable of 2.5mm² and other 20m to the middle of the power distribution), under worst-case conditions. With an impedance of 800m Ω the number of ballasts can be increased by 10%.
2. Measurements will be verified in real installations; therefore data are subject to change.
3. In some cases the maximum number of ballasts is not determined by the MCB but by the maximum electrical load of the installation.
4. Note that the maximum number of ballasts is given when these are all switched on at the same moment, i.e. by a wall switch.
5. Measurements were carried out on single-pole MCB's. For multi-pole MCB's it is advisable to reduce the number of ballasts by 20%.
6. The maximum number of ballasts which can be connected to one Residual Current Detector of 30mA is 60.



凡球照明股份有限公司

台北縣三重市光復路二段 80 號 9 樓之 7

TEL: 02-8512 3888 FAX: 02-8512 3439

<http://www.circleworld.com.tw>

Email: john@circleworld.com.tw